

1

2

3

4

A

Technical data/ Datos técnicos:

According to/En referencia a:	84557583
Operating temperature range/ Rango de temperatura:	-40°C a/to 80°C
Weight/Peso:	63,5 gr

PIN 1-3	Switch 1/Interruptor 1
PIN 2-3	Switch 2/Interruptor 2
PIN 4	GND/Masa
PIN 5	Signal/Señal
PIN 6	+5V

A

B

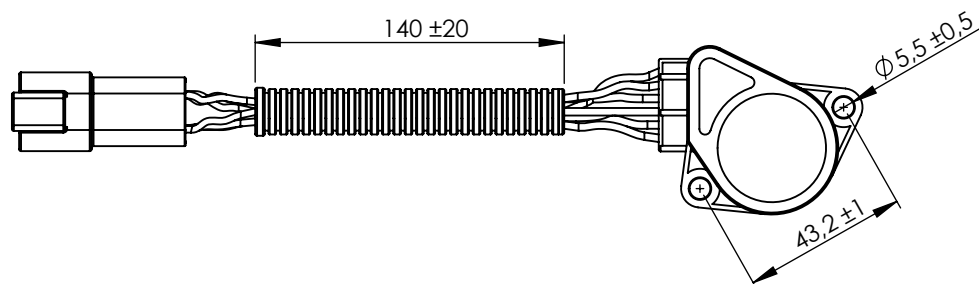

B

C

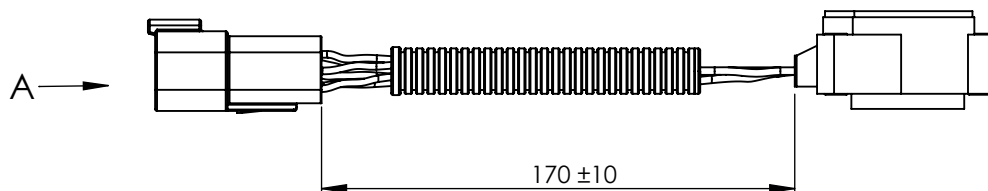

C

D

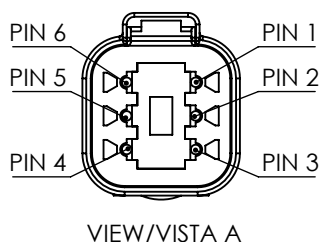

D

E

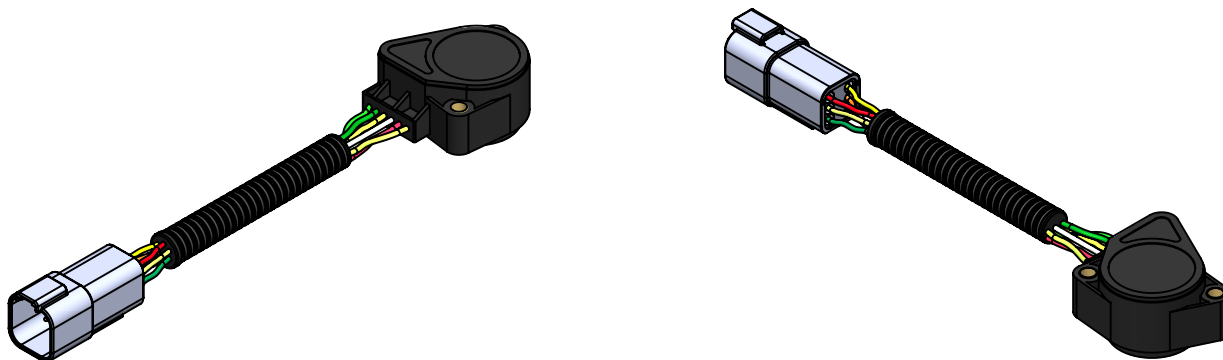

E

F

Modification	4				Drawn
	3				31/08/20 S.F.
	2				Checked
	1				31/08/20 E.L.
nº	Modified	Date	Reason	General Tolerance	Assembly
Comments				ISO 2768 c-K	Part name
				Material	ID. Reference
				-	Scale: 1/2
				-	Review: 0

Accelerator position sensor/
Sensor de posición acelerador

2260490

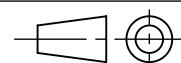
Sheet
1/1

F