

A

Technical data/ Datos técnicos:

According to/En referencia a:	20499271
Operating temperature range/ Rango de temperatura:	-40°C a/to 80°C
Weight/Peso:	59 gr

PIN 4-3	Switch 1/Interruptor 1
PIN 4-7	Switch 2/Interruptor 2
PIN 8	GND/Masa
PIN 2	Signal/Señal
PIN 1	+5V

A

B

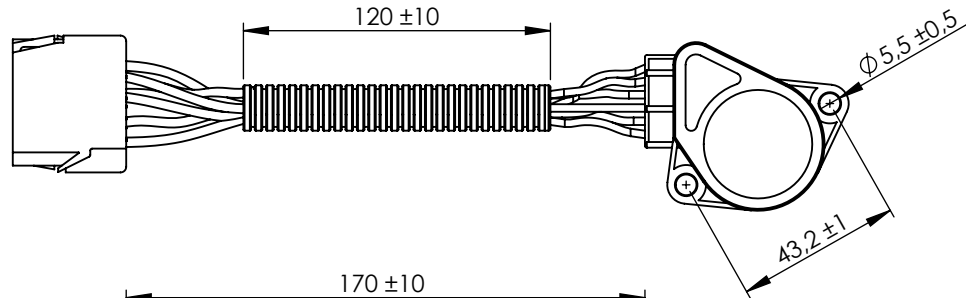

B

C

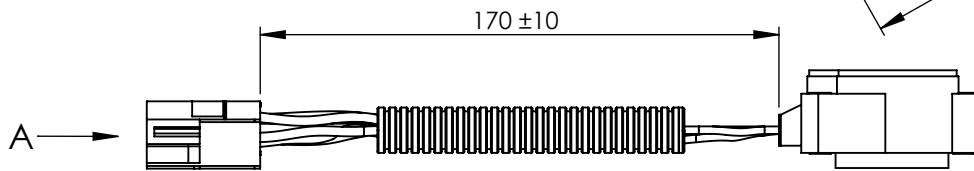

C

D

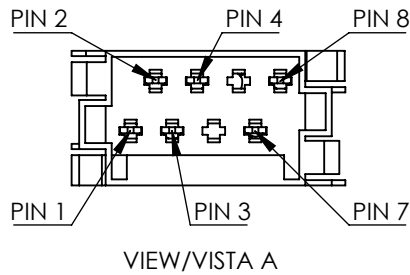

D

E

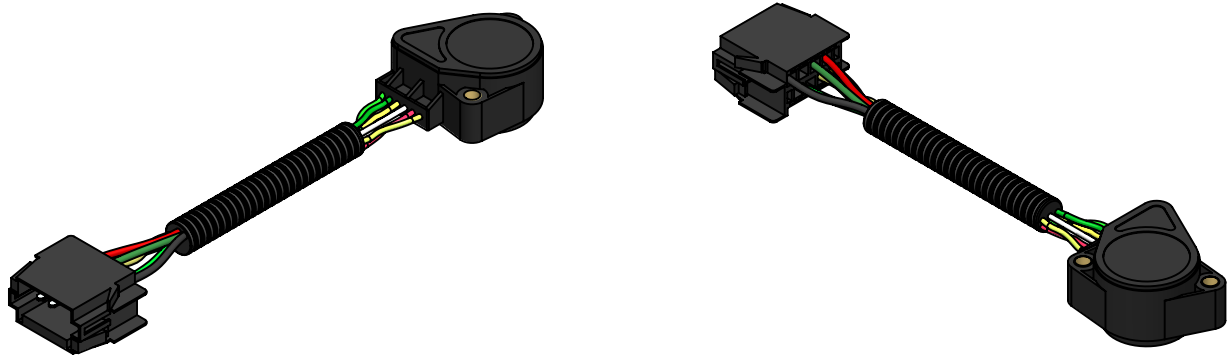

E

F

Modification	4				Drawn	
	3				31/08/20 S.F.	
	2				Checked	
	1				31/08/20 E.L.	
	nº	Modified	Date	Reason	General Tolerance	Assembly
Comments					ISO 2768 c-K	Part name
					Material	ID. Reference
					-	Scale: 1/2
					-	Review: 0



Accelerator position sensor/ Sensor de posición de acelerador	
2260368	
	Sheet 1/1

F