

Introduction

JT2006 infrared thermometer (hereinafter referred as "the thermometer") can quickly and accurately determine the surface temperature by measuring the infrared energy radiated from the target surface. It is suitable for non-contact surface temperature measurement.

Safety Information

Warning:

LAZAR RADIATION DO NOT STARE AT BEAM
OUTPUT < 1mW COMPLIES WITH EN60825-1:2014

To avoid eyes or personal injury, please read the following safety instructions before using the thermometer:

- Please do not aim the laser at people or animals directly or indirectly.
- Please do not look at the laser directly or through other optical tools (telescope, microscope, etc).
- If battery symbol on LCD display is flashing, replace batteries immediately to avoid inaccurate measurements before using the thermometer.
- Inspect the case before using the thermometer. Do not use the thermometer if it is damaged. Look for cracks or missing plastic.
- Please refer to the emissivity information for the actual temperature. Reflective objects can cause the actual temperature value to be higher than the measured temperature value. When measuring these objects, please be aware of not to touch hot surfaces.
- Do not use the thermometer in an explosive gas, steam, or humid environment.
- To ensure measurement accuracy, place the thermometer in the current environment for more than 30 minutes before using it.
- Avoid keeping the thermometer near hot objects for a long time.

Safety Standards

CE Certification: EN61326-1:2013 EN61326-2-2:2013
Laser safety standard: EN60825-1:2014

Reference Standard

JJG 856-2015

Specifications

Temperature range	-20°C~400°C (-4°F~752°F)
Accuracy Ambient temperature 21°C ~ 25°C (70°F ~ 77°F)	>0°C: ±2.0°C or ±2% of reading, whichever is greater ≤0°C: ±(2.0°C + 0.1°C/°C) >32°F: ±4.0°F or ±2% of reading, whichever is greater ≤32°F: ±(4.0°F + 0.1°F/°F)
Temperature coefficient	±0.1 °C/°C or ±0.1 %/°C, whichever is greater (±0.1 °F/°F or ±0.1 %/°F, whichever is greater)
D:S ratio	10:1 (calculated at 90% energy)
Emissivity	0.95
Response time	<500ms (95% of reading)
Spectral response	5.5um ~ 14um
Resolution	0.1°C (0.1°F)
Repeatability	1 °C or 1.0%, whichever is greater (2°F or 1.0%, whichever is greater)
Laser	Single laser, wavelength 630nm~670nm Output power < 1 mW, class 2 laser
Battery type	AAA 1.5V x 2
Battery life	≥ 20H (continuous operation when laser backlight is turned on)
Product size	135x94x36mm
Product weight	About 148g (including batteries)
Operating temperature	0°C~50°C (32°F~122°F)
Storage temperature	-20°C~60°C (-4°F~140°F)
Operating humidity	<RH90% (non-condensing)
Drop test	1m

In the presence of a strong electromagnetic field, the product may obtain up to ± 1.0°C or 20% variation of the measured value. If this variation is observed, move the meter out from the area for accurate measurement.

Product Features

1. Simple one button operation
2. Single laser targeting
3. LCD backlight
4. Auto data hold (8s)
5. Auto power off
6. Low battery indication
7. °C/°F selectable
8. Power-off memory

Product Descriptions

External Structure

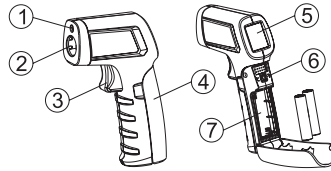

1	Laser	2	Infrared Sensor
3	Trigger	4	Battery cover
5	LCD	6	°C/°F switching button
7	Battery compartment		

LCD Display Function

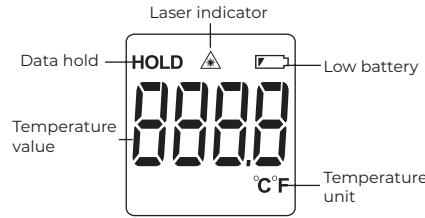

Operations

Viewing the Last Measured Value

In the event of being turned off, short press the trigger to turn on the thermometer, it will display the last measurement data that was taken before the last shutdown.

Temperature Measurement

Aim the thermometer at the target, then pull and hold the trigger, the laser indicator on the LCD display shows that the laser is turned on and points to the target. The measured temperature value will be displayed on the LCD, and the maximum or minimum temperature of the target area can be measured by moving the thermometer up, down, left and right according to the laser spot indication.

Note: The measurement distance must be determined by the size of the measured target according to the "distance to the spot size ratio (D:S)" and "field of view".

Hold

After the trigger is released, the last measured value and the HOLD icon will remain it on the LCD display. If there is no operation for 8 seconds, the thermometer will automatically shut down and save the last measured.

Unit Conversion

When the device is turned on, open the battery cover and short press the °C/°F button to switch the temperature unit to Celsius (°C) or Fahrenheit (°F).

Distance to Spot Size Ratio (D:S)

As the distance (D) from the target being measured increases, the spot size (S) on the measured area becomes larger. The relationship between the distance and the spot diameter is as shown in the figure below. The spot diameter represents 90% of the energy in the circle. The maximum D:S(10:1) will be obtained when the thermometer is 400mm (16") from the target, resulting in a spot diameter of 40mm (1.6").

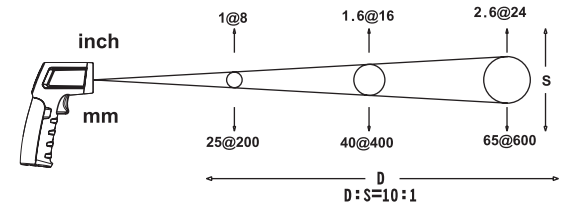

Field of View

Make sure that the measured target is larger than the spot diameter. The smaller the target is, the closer the test distance should be (please refer to D:S for the spot diameter at different distances). To obtain the best measurement result, it is recommended to measure the target 2.5 times larger than the spot diameter.

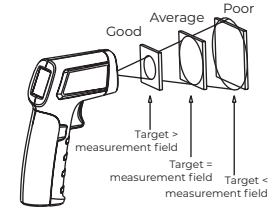

Troubleshooting

Symptom	Problem	Action
"OL" appears when measuring	Measured value is greater than the maximum range	Stop measuring
"OL" appears when measuring	Measured value is less than the minimum range	Stop measuring
"Err" appears when booting	Exceeds the minimum or maximum operating ambient temperature	Place the thermometer in a 0°C~50°C (32°F~122°F) environment, and it can be recovered after 30 minutes
Battery indicator flashes	Low battery	Replace the batteries
Laser fails to work/ weak laser	Low battery	Replace the batteries
The measurement is inaccurate	Low battery, emissivity mismatching, measured distance is too far, measured target diameter is less than 20mm, etc.	Please refer to the instructions for field of view, D:S, etc.

Maintenance

Clean

Blow away particles with clean compressed air, carefully wipe the surface of the lens with a cotton swab moistened with water, and clean the chassis with a damp sponge or a soft cloth.

Battery Replacement

Please install or replace the batteries (AAA (LR03) 2*1.5V) as shown on the right.

