

1

2

3

4

A

A

Technical sheet/ Datos técnicos:

Part number adaptable to / Referencia adaptable a	21116880
Operating temperature range / Rango de temperatura	-40°C a/to 80°C
Weight / Peso	63 gr

B

B

PIN 1	Switch/Interruptor
PIN 3	Switch/Interruptor
PIN 4	GND/Masa
PIN 5	Signal/Señal
PIN 6	+5V

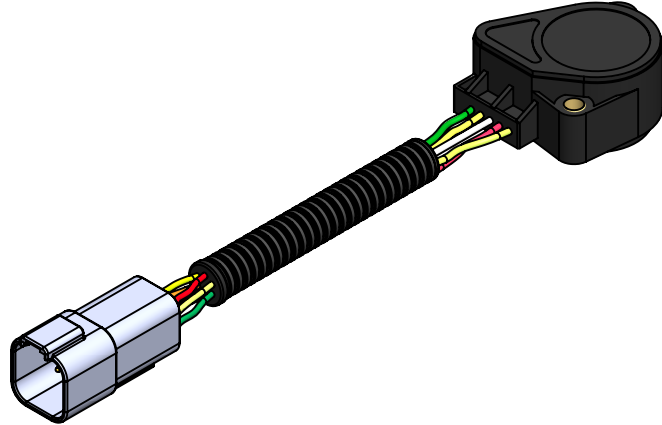

C

C

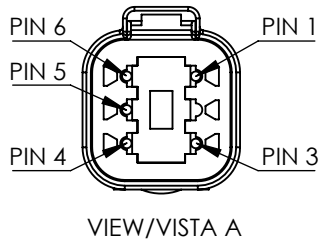

D

D

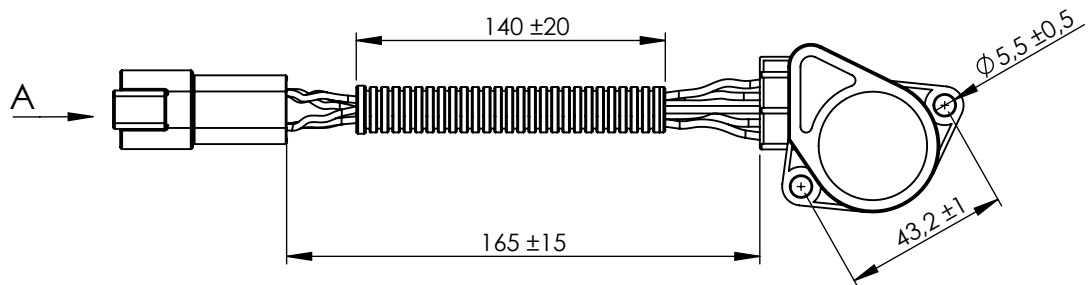

E

E

F

F

Modification	4				Drawn		
	3				31/08/20 S.F.		
	2				Checked		
	1	S.F.	17/11/22	Change sheet format	31/08/20 E.L.		
	nº	Modified	Date	Reason	General Tolerance	Assembly	
Comments					Part name	-	
					Material	Accelerator position sensor/ Sensor de posición acelerador	
					ID. Reference	2260209	
					Scale: 1/2		Sheet 1/1
					Review: 1		